

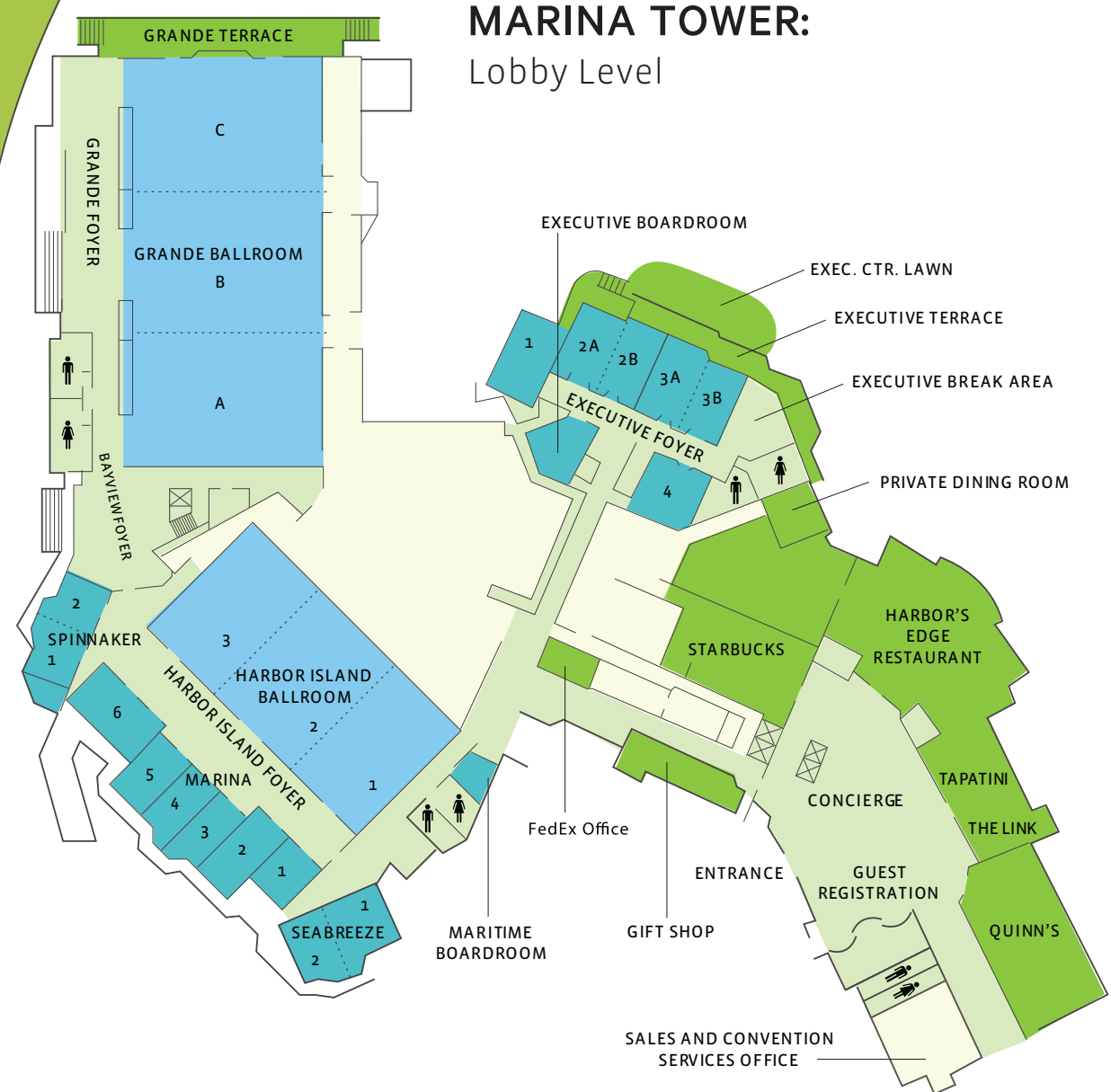

## MARINA TOWER: Lobby Level



MARINA TOWER - LOBBY LEVEL

|                        | SQ FT  | DIMENSION      | HEIGHT | BANQUET | THEATER | RECEPTION | CONF. | CLASS | U-SHAPE | HOLLOW |
|------------------------|--------|----------------|--------|---------|---------|-----------|-------|-------|---------|--------|
| GRANDE BALLROOM        | 14,442 | 174'3" x 84'   | 20'    | 1,400   | 1,600   | 2,100     |       | 1,050 |         |        |
| GRANDE A               | 4,788  | 57' x 84'      | 20'    | 450     | 500     | 685       | 40    | 325   | 80      | 95     |
| GRANDE B               | 4,788  | 57' x 84'      | 20'    | 450     | 500     | 685       | 40    | 325   | 80      | 95     |
| GRANDE C               | 4,866  | 60'3" x 84'    | 20'    | 450     | 500     | 685       | 40    | 325   | 80      | 95     |
| GRANDE TERRACE         | 1,500  | 105'6" x 15'6" |        |         |         | 150       |       |       |         |        |
| GRANDE FOYER           | 3,658  | 172'8" x 33'3" |        |         |         | 1,000     |       |       |         |        |
| HARBOR ISLAND BALLROOM | 9,882  | 143'2" x 70'   | 18'    | 1,000   | 1,200   | 1,450     |       | 730   |         |        |
| HARBOR ISLAND 1        | 3,109  | 44'6" x 70'    | 18'    | 300     | 400     | 475       | 60    | 240   | 70      | 80     |
| HARBOR ISLAND 2        | 3,575  | 54'2" x 66'    | 18'    | 330     | 400     | 475       | 54    | 240   | 70      | 80     |
| HARBOR ISLAND 3        | 3,109  | 44'6" x 70'    | 18'    | 300     | 400     | 475       | 60    | 220   | 70      | 80     |
| HARBOR ISLAND FOYER    | 3,117  | 145' x 30'     |        |         |         | 900       |       |       |         |        |
| SEABREEZE 1 & 2        | 1,617  | 50'9" x 35'8"  | 10'    | 120     | 150     | 200       | 40    | 90    | 45      | 50     |
| SEABREEZE 1            | 994    | 31'6" x 35'8"  | 10'    | 60      | 75      | 120       | 24    | 45    | 28      | 28     |
| SEABREEZE 2            | 623    | 19'3" x 35'8"  | 10'    | 50      | 50      | 80        | 20    | 32    | 20      | 20     |
| SEABREEZE FOYER        | 153    | 17' x 9'       | 10'    |         |         |           |       |       |         |        |
| MARINA 1               | 609    | 26' x 23'6"    | 11'    | 40      | 60      | 80        | 20    | 30    | 24      | 30     |
| MARINA 2               | 746    | 40' x 18'8"    | 11'    | 60      | 90      | 100       | 36    | 56    | 36      | 40     |
| MARINA 3               | 725    | 38'10" x 18'8" | 11'    | 50      | 80      | 90        | 26    | 48    | 26      | 30     |
| MARINA 4               | 725    | 38'10" x 18'8" | 11'    | 50      | 80      | 90        | 26    | 48    | 26      | 30     |
| MARINA 5               | 616    | 33' x 18'8"    | 11'    | 50      | 80      | 90        | 26    | 48    | 26      | 30     |
| MARINA 6               | 1,134  | 43'9" x 26'    | 11'    | 80      | 120     | 150       | 40    | 76    | 40      | 44     |
| SPINNAKER 1 & 2        | 1,322  | 49'4" x 28'8"  | 10'    | 90      | 125     | 174       | 40    | 78    | 42      | 45     |
| SPINNAKER 1            | 684    | 27'9" x 28'8"  | 10'    | 50      | 65      | 94        | 25    | 40    | 25      | 30     |
| SPINNAKER 2            | 638    | 21'7" x 28'8"  | 10'    | 40      | 50      | 80        | 20    | 32    | 20      | 22     |
| MARITIME BOARDROOM     | 291    | 19'3" x 15'    | 11'    | 12      | 24      |           | 20    |       | 10      | 14     |
| BAY VIEW LAWN          | 1,200  |                |        | 1,000   |         | 1,200     |       |       |         |        |

## MARINA TOWER: Lower Level

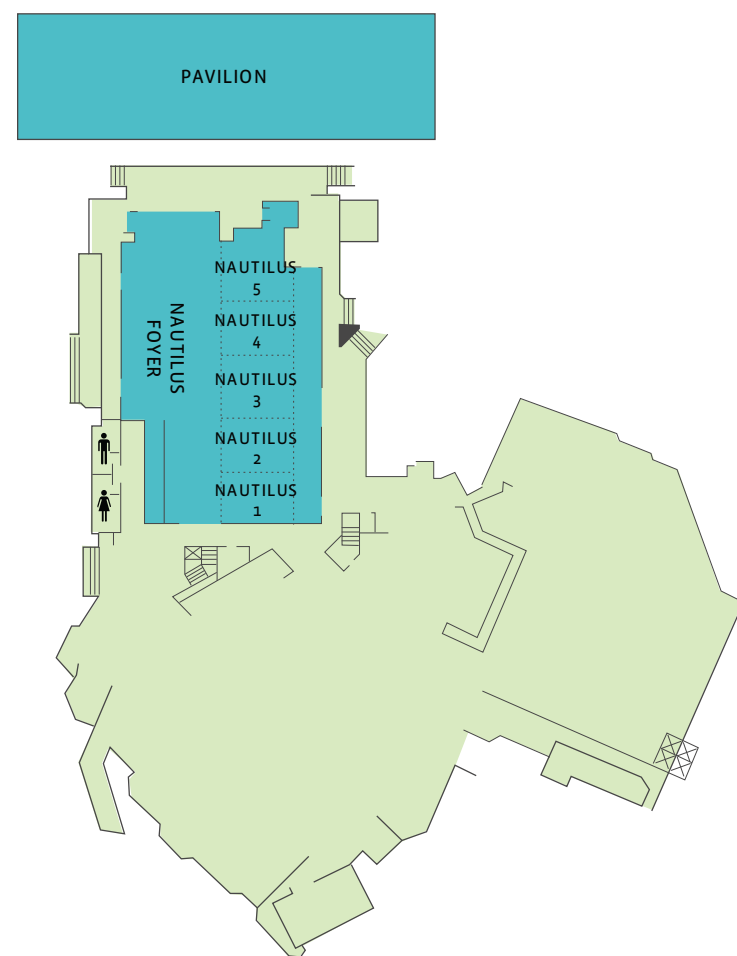

MARINA TOWER - LOWER LEVEL

|                                       | SQ FT  | DIMENSION      | HEIGHT | BANQUET | THEATER | RECEPTION | CONF. | CLASS | U-SHAPE | HOLLOW |
|---------------------------------------|--------|----------------|--------|---------|---------|-----------|-------|-------|---------|--------|
| EXECUTIVE BOARDROOM                   | 585    | 27'10" x 28'4" | 11'6"  |         |         |           | 15    |       |         |        |
| CONFERENCE ROOM 1                     | 1,000  | 40' x 25'      | 11'6"  | 70      | 90      | 70        | 30    | 60    | 30      | 35     |
| CONFERENCE ROOM 2A                    | 734    | 33' x 22'3"    | 11'6"  | 50      | 65      | 50        | 24    | 40    | 25      | 30     |
| CONFERENCE ROOM 2B                    | 759    | 37'6" x 20'3"  | 11'6"  | 50      | 65      | 50        | 24    | 40    | 25      | 30     |
| CONFERENCE ROOM 2A & 2B               | 1,594  | 42'6" x 37'6"  | 11'6"  | 100     | 150     | 125       | 40    | 80    | 35      | 40     |
| CONFERENCE ROOM 3A                    | 787    | 37'6" x 21'    | 11'6"  | 50      | 65      | 50        | 24    | 40    | 25      | 30     |
| CONFERENCE ROOM 3B                    | 761    | 36'3" x 21'    | 11'6"  | 50      | 65      | 50        | 24    | 40    | 25      | 30     |
| CONFERENCE ROOM 3A & 3B               | 1,575  | 42' x 37'6"    | 11'6"  | 100     | 150     | 125       | 40    | 80    | 35      | 40     |
| CONFERENCE ROOM 4                     | 907    | 34'8" x 31'6"  | 11'6"  | 50      | 80      | 65        | 24    | 50    | 25      | 30     |
| EXECUTIVE FOYER                       | 3,990  | 95'7" x 42'    | 11'6"  | 180     |         | 200       |       |       |         |        |
| EXECUTIVE TERRACE                     | 1,652  | 136' x 39'     | 11'6"  | 80      |         | 200       |       |       |         |        |
| EXEC. CTR. LAWN                       | 1,972  | 68' x 29'      |        | 190     |         | 275       |       |       |         |        |
| EXECUTIVE BREAK AREA                  | 723    | 29'6" x 34'    | 11'6"  |         |         | 60        |       |       |         |        |
| * PAVILION                            | 20,000 | 200' x 100'    | 32'    | 1,650   | 2,000   | 2,500     | 1,400 | 96'   |         |        |
| PARLOR CONFERENCE ROOMS<br>411 OR 415 | 485    | 25'6" x 27'6"  | 8'     | 30      | 35      | 45        | 20    | 20    |         |        |
| 411/415                               | 970    | 51' x 27'6"    | 8'     |         |         | 80        |       |       |         |        |
| 511, 514, 515 & 518                   | 485    | 25'6" x 27'6"  | 8'     | 30      | 35      | 45        | 20    | 20    |         |        |
| NAUTILUS & FOYER                      | 14,874 | 134' x 11'1"   | 10'    | 1,400   |         | 170       |       |       |         |        |
| NAUTILUS 1, 2, 3, OR 4                | 1,638  | 63' x 26'      | 10'    | 150     | 180     | 230       | 50    | 110   | 60      | 70     |
| NAUTILUS 5                            | 2,694  | 63' x 63'      | 10'    | 180     |         | 200       | 50    | 110   | 60      | 70     |
| NAUTILUS FOYER                        | 5,168  | 152' x 34'     | 10'    | 300     |         | 170       |       |       |         |        |

\* 93-100 EXHIBIT BOOTHS \* = OUTSIDE VENUES REFER TO CAMPUS MAP ON BACK

## BAY TOWER: Lobby Level

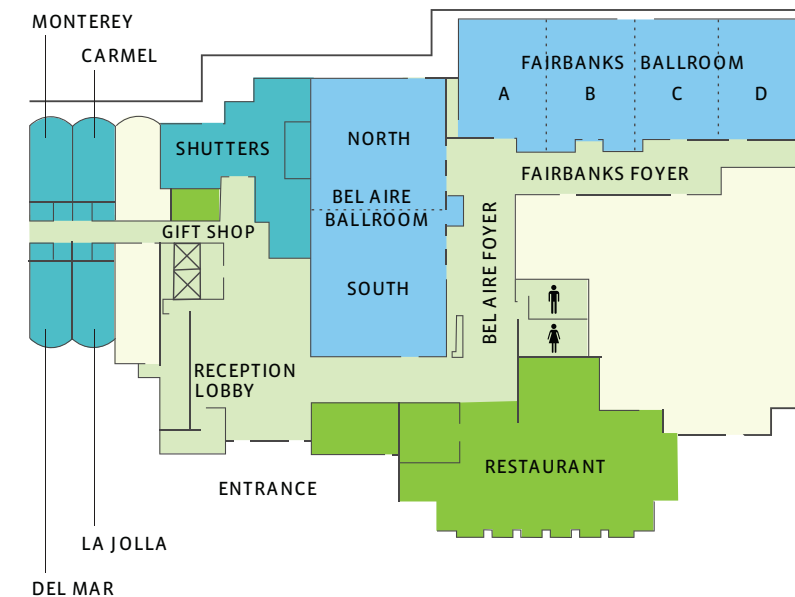

- BALLROOMS
- MEETING ROOMS
- PUBLIC AREAS
- SERVICE AREAS

## BAY TOWER: Upper Level

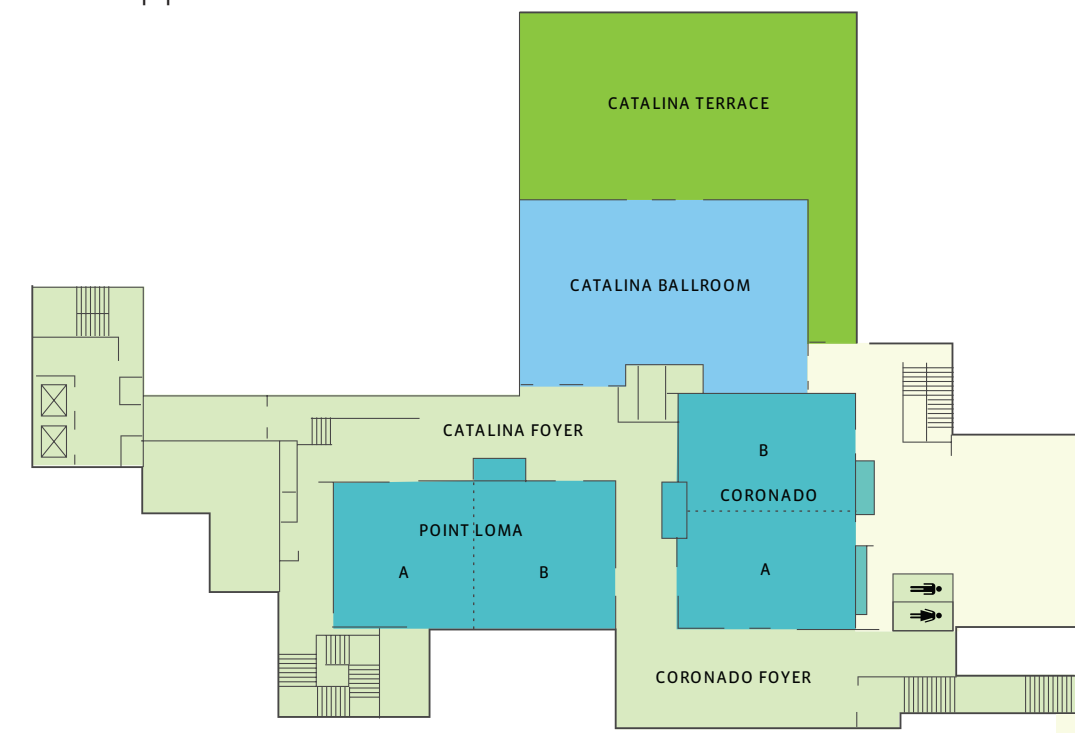

BAY TOWER - LOBBY LEVEL

|                    | SQ FT | DIMENSION    | HEIGHT | BANQUET | THEATER | RECEPTION | CONF. | CLASS | U-SHAPE | HOLLOW |
|--------------------|-------|--------------|--------|---------|---------|-----------|-------|-------|---------|--------|
| BEL AIRE BALLROOM  | 4,218 | 93'3" x 45'  | 13'6"  | 360     | 500     | 500       | 86    | 275   | 100     | 115    |
| BEL AIRE NORTH     | 2,092 | 45' x 46'    | 13'6"  | 170     | 240     | 250       | 40    | 125   | 54      | 65     |
| BEL AIRE SOUTH     | 2,126 | 45' x 46'9"  | 13'6"  | 170     | 240     | 250       | 40    | 125   | 54      | 65     |
| BEL AIRE FOYER     | 1,261 | 17' x 74'2"  |        |         |         |           |       |       |         |        |
| FAIRBANKS BALLROOM | 4,600 | 120' x 38'6" | 9'10"  | 420     | 450     | 500       | 108   | 300   | 120     | 132    |
| TERRACE A          | 1,150 | 30' x 38'6"  | 9'10"  | 90      | 100     | 125       | 25    | 65    | 34      | 44     |
| TERRACE B          | 1,150 | 30' x 38'6"  | 9'10"  | 90      | 100     | 125       | 25    | 65    | 34      | 44     |
| TERRACE C          | 1,150 | 30' x 38'6"  | 9'10"  | 90      | 100     | 125       | 25    | 65    | 34      | 44     |
| TERRACE D          | 1,150 | 30' x 38'6"  | 9'10"  | 90      | 100     | 125       | 25    | 65    | 34      | 44     |
| FAIRBANKS FOYER    | 841   | 70'1" x 12'  |        |         |         |           |       |       |         |        |
| MONTEREY           | 401   | 31' x 14'    | 7'9"   | 30      | 40      | 40        | 20    | 20    |         |        |
| CARMEL             | 401   | 31' x 14'    | 7'9"   | 30      | 40      | 40        | 20    | 20    |         |        |
| LA JOLLA           | 401   | 31' x 14'    | 7'9"   | 30      | 40      | 40        | 20    | 20    |         |        |
| DEL MAR            | 401   | 31' x 14'    | 7'9"   | 30      | 40      | 40        | 20    | 20    |         |        |
| SHUTTERS           | 1,184 | 58'9" x 48'  | 9'9"   | 100     | 70      | 70        | 24    | 35    |         |        |

BAY TOWER - UPPER LEVEL

|                   | SQ FT | DIMENSION     | HEIGHT | BANQUET | THEATER | RECEPTION | CONF. | CLASS | U-SHAPE | HOLLOW |
|-------------------|-------|---------------|--------|---------|---------|-----------|-------|-------|---------|--------|
| POINT LOMA ROOM   | 1,770 | 59' x 30'     | 11'4"  | 160     | 180     | 220       | 48    | 98    | 57      | 60     |
| PT LOMA A         | 885   | 29'6" x 30'   | 11'4"  | 80      | 90      | 120       | 26    | 48    | 26      | 30     |
| PT LOMA B         | 885   | 29'6" x 30'   | 11'4"  | 80      | 90      | 120       | 26    | 48    | 26      | 30     |
| CORONADO ROOM     | 1,776 | 37' x 48'2"   | 11'1"  | 120     | 180     | 180       | 40    | 90    | 42      | 48     |
| CORONADO A        | 888   | 37' x 24'6"   | 11'1"  | 60      | 90      | 90        | 26    | 45    | 26      | 30     |
| CORONADO B        | 888   | 37' x 24'6"   | 11'1"  | 60      | 90      | 90        | 26    | 45    | 26      | 30     |
| CORONADO FOYER    | 869   | 48'3" x 18'   |        |         |         |           |       |       |         |        |
| CATALINA BALLROOM | 2,252 | 59'8" x 39'   | 11'7"  | 180     | 250     | 300*      | 48    | 110   | 57      | 65     |
| CATALINA TERRACE  | 2,586 | 66' x 39'3"   |        | 176     |         | 160       |       |       |         |        |
| CATALINA FOYER    | 805   | 59'3" x 13'7" |        |         |         |           |       |       |         |        |

\* = INCLUDES TERRACE

RESTAURANTS AND THE LINK

|                                   | SQ FT | DIMENSION  | HEIGHT | BANQUET | THEATER | RECEPTION | CONF. | CLASS | U-SHAPE | HOLLOW |
|-----------------------------------|-------|------------|--------|---------|---------|-----------|-------|-------|---------|--------|
| TAPATINI AND THE LINK             | 560   | 23' x 24'  | 10'6"  | 40      |         | 40        |       |       |         |        |
| HARBOR'S EDGE PRIVATE DINING ROOM | 6121  | 103' x 59" | 12'5"  | 420     |         | 400       |       |       |         |        |
| HARBOR'S EDGE RESTAURANT          | 1,224 | 68' x 18'  | 8'     | 80      |         | 148*      |       |       |         |        |
| QUINN'S                           | 3,249 | 57' x 57'  | 9'     | 90      |         | 150       |       |       |         |        |

^ = CALIFORNIA LIQUOR LAW IS 148 MAXIMUM OCCUPANCY \* = OUTSIDE VENUES REFER TO CAMPUS MAP ON BACK